

**NORTHROCK BUSINESS PARK**  
**8200 E 34th St N, Bldg 1400, Suite #1404 Wichita, Kansas**  
**Office Space For Lease**



### **PROPERTY FEATURES**

- 18 buildings - 300,000 SF
- Lush landscaping
- Adjacent to K-96 Hwy.
- Door-side parking
- On-site property management
- On-site US Mail & UPS drop boxes
- Walking path
- 2 gazebos
- Individual tenant signage
- Landscaped lake area
- Extra storage space ([U-Stor Northrock](#))
- Security patrols at night
- Fiber optics
- More details at [northrockbp.com](http://northrockbp.com)

### **SUITE #1404**

- 7,500 SF available
- Reception Area
- 8 Offices
- Open Office
- Conference room
- Copy/File Room
- Break room
- Large Cubicle (50) area
- Backup UPS System
- **\$9,100 / month**  
**(Modified Gross)**



3450 N. Rock Road #201  
Wichita, KS 67226  
[amcwichita.com](http://amcwichita.com)

FOR INFORMATION  
**Contact Ross Way**  
**(316) 681-1711**  
[ross@amcwichita.com](mailto:ross@amcwichita.com)

# NORTHROCK BUSINESS PARK

8200 E 34th St N, Bldg 1400, Suite #1404 Wichita, Kansas  
Office Space For Lease

## INTERIOR PHOTOS

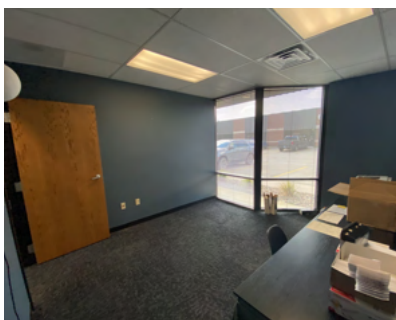

3450 N. Rock Road #201  
Wichita, KS 67226  
amcwichita.com

FOR INFORMATION  
Contact Ross Way  
**(316) 681-1711**  
ross@amcwichita.com

**NORTHROCK BUSINESS PARK**  
8200 E 34th St N, Bldg 1400, Suite #1404 Wichita, Kansas  
Office Space For Lease

**FLOOR PLAN**



3450 N. Rock Road #201  
Wichita, KS 67226  
amcwichita.com

FOR INFORMATION  
**Contact Ross Way**  
**(316) 681-1711**  
ross@amcwichita.com

# NORTHROCK BUSINESS PARK

8200 E 34th St N, Bldg 1400, Suite #1404 Wichita, Kansas  
Office Space For Lease

## LOCATION/AERIAL



3450 N. Rock Road #201  
Wichita, KS 67226  
amcwichita.com

FOR INFORMATION  
Contact Ross Way  
**(316) 681-1711**  
ross@amcwichita.com

# NORTHROCK BUSINESS PARK

8200 E 34th St N, Bldg 1400, Suite #1404 Wichita, Kansas  
Office Space For Lease

## NORTHROCK BUSINESS PARK SITE PLAN

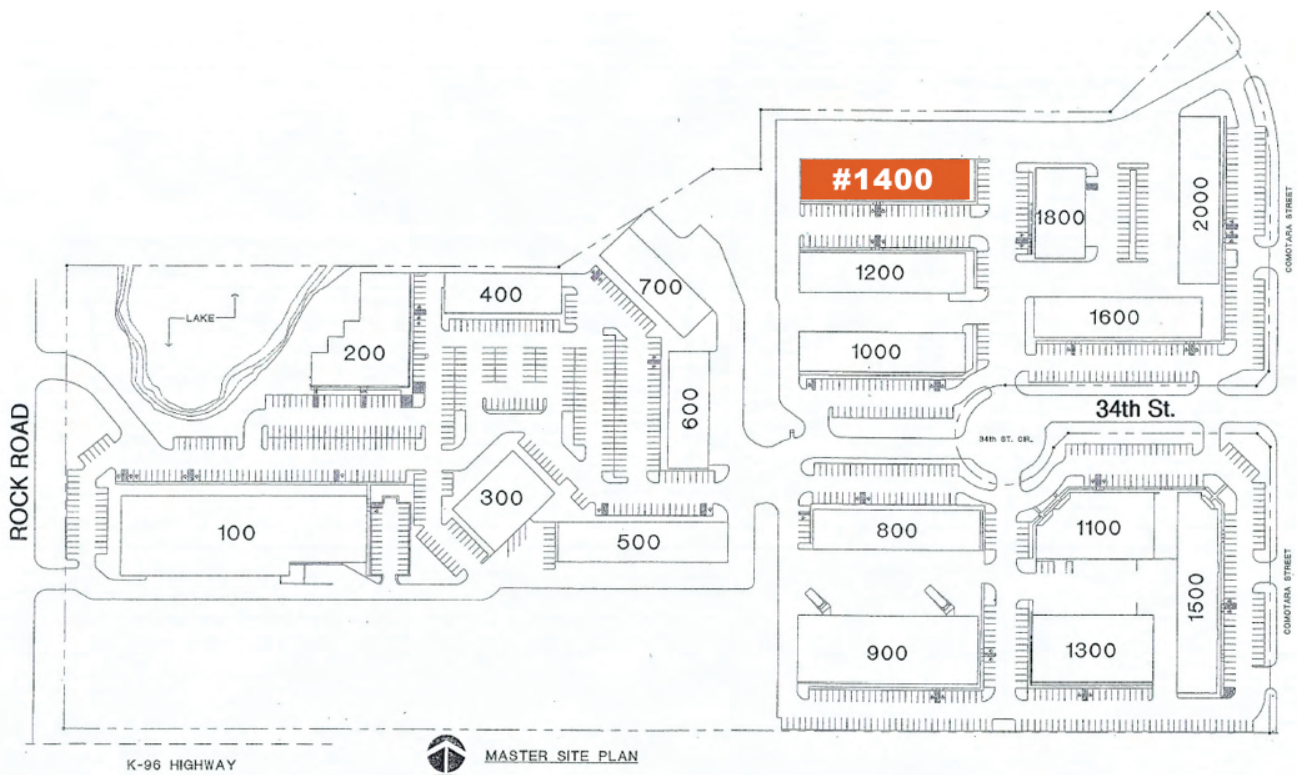

3450 N. Rock Road #201  
Wichita, KS 67226  
amcwichita.com

FOR INFORMATION  
Contact Ross Way  
**(316) 681-1711**  
ross@amcwichita.com